

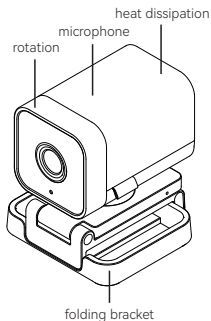

Product Introduction

AI Streamcam AC400

1. Full HD picture output, up to 1080P/30fps
2. AI gesture control, human face recognition tracking, 2x zoom
3. Landscape and portrait modes supported, motorized horizontal rotation range: ± 150 degrees
4. Built-in dual omnidirectional microphones with pickup range of up to 2.4m for HD audio
5. Type-c universal interface for wide compatibility
6. Standard USB drive free protocol, supports mainstream operating system , Plug and Play

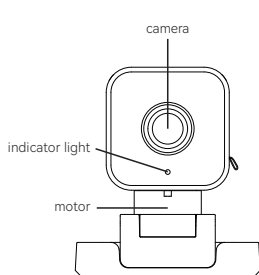

Use Guide

1 SETUP

Setup the camera on a computer or on a tripod.

- Open the base
- Attach the camera to the monitor
- The general standard 1/4" port at the bottom can be connected to any tripods and other equipment

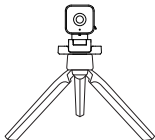
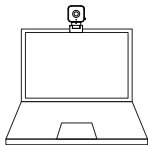

2 CONNECT

Connect the camera to computer with the included USB cable. It will take a few seconds for the first time usage before attempting to access.

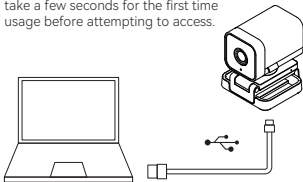

3 PLUG AND PLAY

Not need to install any drivers. Start your video call from your computer.



Gesture Control

Gesture 1 "OK" Start tracking

When the camera is turned on, make "gesture 1" and the camera starts tracking and shooting accurately.



Gesture 2 "L" Zoom in and zoom out

Zoom in with "gesture 2" while filming, zoom in to the second level and do this gesture again, which means to begin zooming out.



Gesture 3 "Palm" Stop tracking

Make "gesture 3" in the shooting state, and the camera stops tracking.

- Make the gesture last for 3 seconds to remove the watermark.

▲ Note : When making gestures, please be careful not to cover your face with your hands.



Modes

● Tracking mode

- 1.Tracking Target: who makes the Gesture 1 "OK" ;
- 2 Camera tracks Target ONLY;
- 3 ONLY Target can stop the tracking;
- 4 Target lost, ANYONE can stop the tracking;

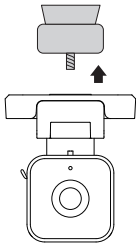

● Flip mode

You can make it mount upside down on a tripod or other gear to activate the Flip Mode.

● Portrait mode

Rotate the camera lens cover 90 degrees clockwise to activate the vertical shooting mode.

- Landscape/Portrait Mode switching requires a few seconds to restart the camera to get activated.
- Use gestures normally in the portrait mode.

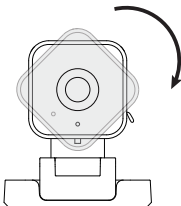

Indicator status

Indicator status	Device status
Off	Standby
Solid white	Streaming
Flashing white 3 times	Landscape/Portrait Mode Switched
Solid green	Tracking mode
Flashing green	Tracking mode, target lost
Solid red	Error
Flashing red	Firmware update

Product Parameters

Brands	AICOCO
Included	AI streamcam AC400 ,USB- C to A cable , Privacy cover
Image	1920*1080 (30fps) , 1280*720 (30fps) , 2x zoom
Lens	DFOV 90°
Motor	Structure rotation range: horizontal ±180 °, motorized controllable rotation range: horizontal ±150 °
Audio	Built-in dual omnidirectional microphones, mic range up to 2.4 meters
Interface	USB-C 2.0
Compatibility	Windows 7 or above, MacOS 10.7 or above, Chrome OS and Android OS
Operating Temperature	0~40℃
Storage Temperature	-20℃~60℃

Disclaimer

Please read this Disclaimer carefully. Using this product means that you acknowledge and accept the terms of this disclaimer. By using this product, you hereby acknowledge and agree that you are solely responsible for your own conduct when using this product and any consequences thereof. You agree to use this product only for proper and lawful purposes. You understand and agree that Chuan xin Ying chuang (Shenzhen) Technology Co., Ltd. (hereinafter referred to as 'Aicoco') accepts no liability for any and all misuse, consequences, damages, injuries, penalties, or any other legal responsibility directly or indirectly incurred by your using this product and associated accessories. Before every use, make sure that your accessories are functioning properly. If there's any damage or irregularity, stop using them immediately. Within the scope of state laws and regulations, Aicoco reserves the right of final explanation and revision for the commitment.

Warranty

Committed to providing best product and service, Aicoco provides one -year warranty (replacement of shell, product appearance, accessories and faulty products caused by non -artificial damage).

Email: service@aicoco.com

Official Web: www.aicoco.com

www.aicoco.com

产品介绍

智能跟拍网络摄像头 AC400

1. 全高清画质输出，最高达1080p/30fps;
2. AI智能手势控制，人脸识别精准追踪，手势智能变焦2挡自动调节;
3. 支持水平和竖直拍摄模式，电动可控水平转动范围： ± 150 度;
4. 内置双、全向麦克风，支持2.4米范围内高清拾音;
5. Type-C通用接口，适配兼容性更广泛;
6. 标准的USB免驱协议，支持主流操作系统即插即用。

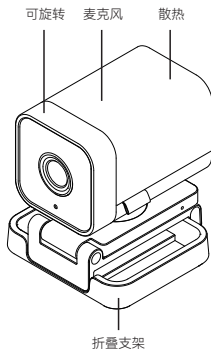
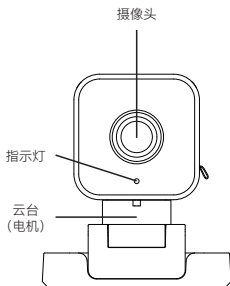

使用方法

① 安装

将相机安装在电脑上或三角架上。

- 打开底部的折叠支架
- 将摄像头固定到显示器上
- 底部通用标准1/4螺母接上任意三脚架等器材

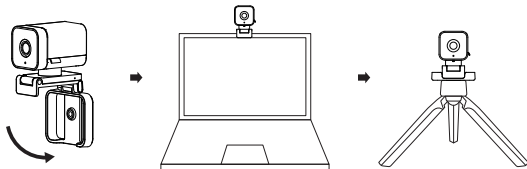

② 连接

将数据线连接摄像头和计算机，等待电脑缓冲几秒钟。

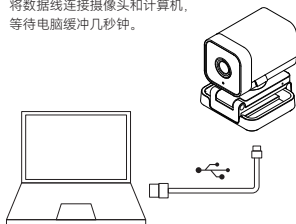

③ 即插即用

不需要安装任何驱动。



手势控制

手势1 “OK” 开始追踪

开机状态对着摄像头做出“手势 1”，摄像头便开始精准追踪拍摄。



手势2 “L” 缩放

拍摄状态下做“手势 2”便放大, 放大到第 2 档之后, 再做此手势是缩小。



手势3 “手掌” 暂停追踪

拍摄状态下做出“手势 3”，摄像头暂停追踪。

- 手势持续3秒关闭/开启logo显示



▲ 注意：做手势时，请注意不要用手遮住脸。

模式说明

● 追踪模式

- 1.. 摄像头只追踪发起追踪的人（即追踪目标）；
2. 只有追踪目标能停止追踪；
3. 目标丢失，任何人都能停止追踪

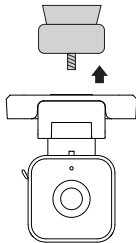

● 倒装模式

你可以让它倒挂在三角架或其他装备上，以激活倒装模式。

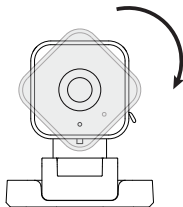

● 竖拍模式

将摄像头镜头盖顺时针旋转 90 度，从而激活竖拍模式。

- 水平模式或者竖拍模式的切换需要几秒钟的时间来重新启动相机，以获得激活。
- 在竖拍模式中正常使用手势。

指示灯

指示灯状态	摄像头状态
灯灭	摄像头未连接，或正常待机状态
白灯常亮	视频开启
白灯闪烁 3 下	水平 / 竖拍模式切换成功
绿灯常亮	追踪模式
绿灯持续闪烁	追踪模式，但目标用户丢失状态
红灯常亮	摄像头报错
红灯持续闪烁	摄像头更新固件中

产品参数

品牌	AICOCO
配件	智能跟拍网络摄像头 AC400、USB-C to A 数据线 x1、镜头隐私遮盖 x1
影像	1920*1080 (30fps)，1280*720 (30fps)，数码变焦 2x
镜头	DFOV 90 度
云台	结构转动范围：水平 ±180°，电动可控转动范围：水平 ±150°
音频	内置双全向麦克风，最大拾音范围 2.4 米
接口	USB-C 2.0
兼容性	windows 7 或以上，MacOS 10.7 或以上，Chrome OS 和 Android OS，主流通讯（微信、QQ、skype）、会议（teams、zoom、腾讯会议、钉钉、飞书）、直播平台及软件（OBS、youtube、facebook、twitch、抖音、淘宝、B 站）
工作温度	0-40 摄氏度
存储温度	负 20-60 摄氏度

免责声明

请仔细阅读本声明，一旦使用本产品，即视为对本声明的全部认可和接受。每次使用前，请仔细检查产品，若出现破损、变形，请勿使用。使用本产品，就意味着您认可并同意，您将对使用本产品的行为和可能产生的后果负全部责任。您承诺仅会出于正当合法的目的使用本产品。您理解并同意，对于直接或间接因使用本产品而造成的滥用、不利影响、损害、伤害、惩罚或者其他法律后果，传心影创（深圳）技术有限公司（以下简称“Aicoco”）将不承担任何责任。用户应遵循包括但不限于本文提及的使用注意事项。在国家法律法规范围内，本承诺解释权、修改权归 Aicoco 所有。

售后服务

自您最初零售购入之日起，本产品的保修期为1年。
(更换外壳、产品外观、配件和非人为损坏的故障产品)。

邮箱: service@aicoco.com

官网: www.aicoco.com